



Celltac α

Automated Hematology Analyzer
MEK-6510K

A reliable partner in your laboratory

User-friendly compact design

Based on over 40-year experience in manufacturing hematology analyzers, Nihon Kohden's Celltac α provides stress-free operation with newly designed hardware and software interface.

Flexible aspiration modes

Celltac α has several blood aspiration modes. Capillary mode enables 10 μ L of blood sampling from neonate or infant earlobe, heel.

Large data capacity

Celltac α uses SD cards for reliable data storage. Over 15,000 results can be stored.

Stress-free

Flexible

Reliable



Fighting Disease with Electronics



A Reliable Partner in Your Laboratory

- 19 parameters + 3 histogram
- High Reproducibility & Accuracy
- Low sample volume
- Low reagent consumption
- 60 samples per hour
- Smart double bath mixing
- Twin dilution sampling nozzle
- Touch Color LCD display
- QC management software
- Serial & USB interface
- Easy maintenance

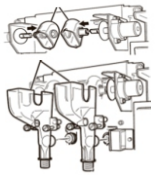

Double Mixing Mechanism

Sub bath mixing chamber for complete mixing that ensures complete uniformity of the cells throughout the solution for high reproducibility and accuracy.

Twin Dedicated Diluting Nozzles

Two dedicated diluting nozzles to avoid carryover and to achieve precise dilution for both the separate chambers RBC/PLT & WBC/Hb.



Capillary Mode

Direct EDTA capillary mode by just a finger pricking. Only 10µl blood with a least CV% as compare to the normal mode. This is very useful for neonatal & pediatric cases.



Large Color Touch Display

TFT 5.7" (240×320 pixels) resolution with Color touch screen for easy and intuitive operations. Histograms and numerical data can be shown on the same.

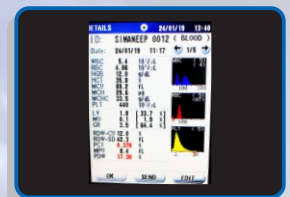

Automatic Clog Removal

To prevent clogging, Celtac removes blood protein and dust particles from the aperture by a high voltage clog shattering electrical pulse after each measurement.



Get CBC done by just finger prick by 10µl only

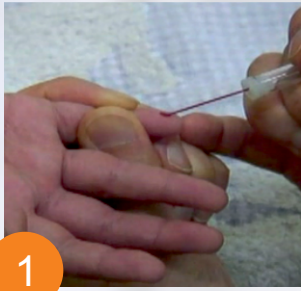

1

Take sample (10µl)

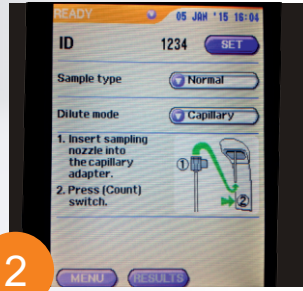

2

Select Capillary mode



3

Aspirate sample



4

Get your result

Data View cum Flag View



Floating threshold for RBC and PLT

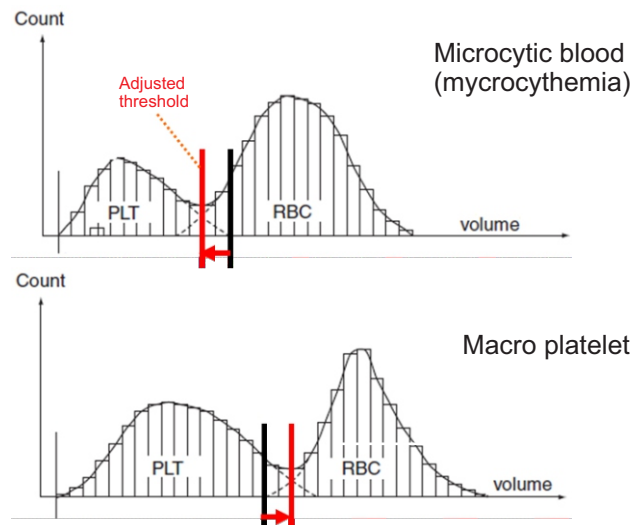

PLT Panic Values Recount

Panic value threshold can be adjusted for recount the sample to achieve more reliable data of cytopenic sample.

Onscreen Data Editing

Measurement data can be searched by ID, sample type and flags. The results can be printed or deleted. You can also edit the ID or view detailed data of the searched samples.

Cyanide-free Reagent

Celltac uses cyanide-free hemolynac • 3N hemolysing reagent for safety and environmental reasons.

Data Security

A password is required to access the setting menu for calibration coefficient, normal range, quality control, and other items. This helps prevent mishandling and safeguard patient information.

Selectable Reference

Ranges of each parameter vary in order to different sampling. It can be customize upper and lower limits individually.

Low Sample Volume

Just 10µL of blood needed for Pre-Dilution mode. 10 or 20µL blood measurement is available which is especially useful for infants and pediatric samples. * In normal measurement, 30µL is required.

Handheld Barcode Reader (optional)

Celltac can use a handheld barcode reader. This assures proper management of different patient's sample.

Specifications

Parameters	WBC, LY%, MO%, GR%, LY, MO, GR, RBC, HGB, HCT, MCV, MCH, MCHC, RDW-CV, RDW-SD, PLT, PCT, MPV, PDW
Measurement methods	WBC, RBC, PLT – impedance method HCT – calculation from histogram HGB – cyanmethemoglobin optical detection WBC differential – calculation from histogram
Measurement modes	Open Pre-dilution WBC high WBC low Capillary
Counting time	60 sec/sample (Open mode)
Sample volume aspirated	30 μ L (CBC) for normal measurement mode 10 or 20 μ L for pre-dilution mode, 10 μ L for capillary mode
Data storage	Over 15,000 results including histograms can be stored on an SD card.
LCD display	5.7 inch 240 \times 320 dots TFT-LCD
Dimensions	230 W \times 450 D \times 428 H (mm)
Weight	Approx. 20 kg

Reagents, Controls, Calibrator



Hematology control

MEK-3DN (normal) T455
 MEK-3DL (low) T455L
 MEK-3DH (high) T455H
 (2mL)



Calibrator

MEK-CAL T457
 (2mL)

Hemolyzing reagent for CBC

HEMOLYNAC-3N
 Cyanide-free

Diluent

ISOTONAC-3

Detergent

CLEANAC

Detergent (Bleach)

CLEANAC-3

Option



SD card

QM-001D Y154D
 QM-002D Y154E
 Up to 15,000 results
 can be stored

Consumable



Micro capillary adaptor

YZ-0373A T810B

Over 40 Years of Experience with In Vitro Diagnostic

Nihon Kohden launched its first automatic blood cell counter, MEK-1100 in 1972. Over the years, the models with more extensive and advanced capabilities are continually developed.



SD is a trademark of SD-3C, LLC.

This brochure may be revised or replaced by Nihon Kohden at any time without notice.

Fighting Disease with Electronics



NIHON KOHDEN INDIA PVT. LTD.

308, Tower-A Spazedge, Sector-47,
 Sohna Road, Gurgaon 122002 Haryana, India
 Phone: +91 124 4931000 (28 Lines)
 Fax: +91 124 4931029
 Email: info_nki@nkc.co.jp

NIHON KOHDEN CORPORATION

1-31-4 Nishiochiai, Shinjuku-ku,
 Tokyo 161-8560, Japan
 Phone: +81 (3) 5996-8036
 Fax: +81 (3) 59968100
 www.nihonkohden.com